

Wenzhou Safewire Electric CO. ,Ltd.

# SPECIFICATION SHEET

**PRODUCT NAME:      Desktop socket**

**PRODUCT No. :              FX-ZSG-A**



Address:2nd floor, Wealth Garden, Liushi town, Yueqing, Wenzhou,China ,325604

Tel:0086-577-61725369

Mob:0086-18612380398

ZIP:325604

(E-mail) : [info@safewirele.com](mailto:info@safewirele.com)

(WEB): <http://www.safewirele.com>

**Tel:0086-577-61725369;**

**Email:[info@safewirele.com](mailto:info@safewirele.com);**

**<http://www.safewirele.com>**

## Quick Details:

Serial No.	Parameter	Description
1	Safewire item	FX-ZSG-A
2	Panel Material	Aluminum alloy
3	Power bar Dimension(mm)	260*158
4	Base box (mm)	233*129
5	Configuration of modules	Power outlet+Data outlet or USB charging: Customized as required
6	Feature	Dual flip without spring
7	G.W/CTN(KGS)	10.6
8	MEASUREMENT/CNT(CN)	52*28.5*29.5
9	TOTAL(M <sup>3</sup> )	0.044
10	Set/CNT	12

## Application:

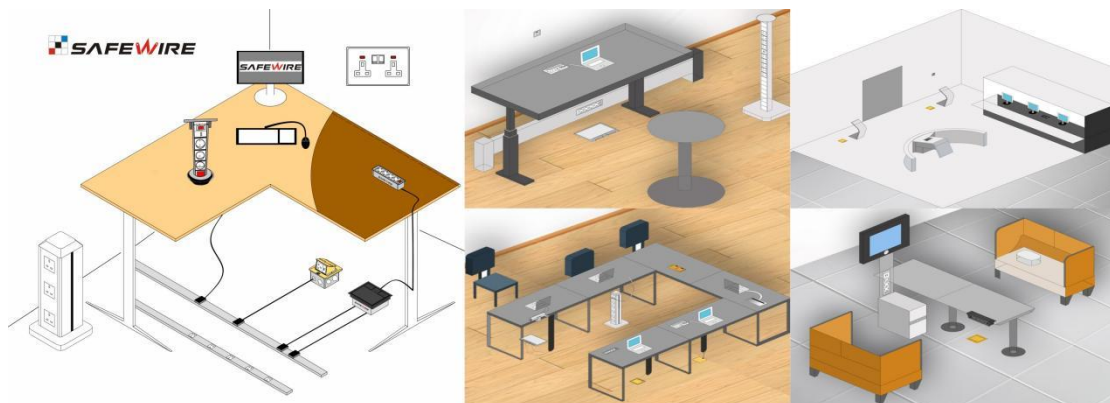

## 1.Feature of Safewire Recessed socket :

1.Modular design for Configuration of power supply and communication,45\*45mm modular,86 type switch and Internation Brand data etc.



**SAFEWIRE**

Wenzhou Safewire Electric Co.,Ltd.

2nd floor, Wealth Garden, Liushi town, Yueqing, Wenzhou,China ,325604

**SAFEWIRE**



2.Recessed in the top of desk/table , simply press down to open it with Spring clip.

**SAFEWIRE**



3.Be closed while device have been plugged in and without crushing the cables.

**SAFEWIRE**



FZ-521C



Side-mounting

## 2. Advantage of Safewire Recessed socket :

1.Configuration and dimension can be customization.

**SAFEWIRE**



6 way



8 way

2.Anodised Ev1 Aluminum/Brushing wire drawing flap , optional black powder-coated housing.



FZ-L002A/B



**3.Adjustable built-in frame fitting for more optional plug clearance.**



## 3.Specification of Safewire Recessed socket:

**A)Product dimension:**

FX-ZSG-A Units: mm

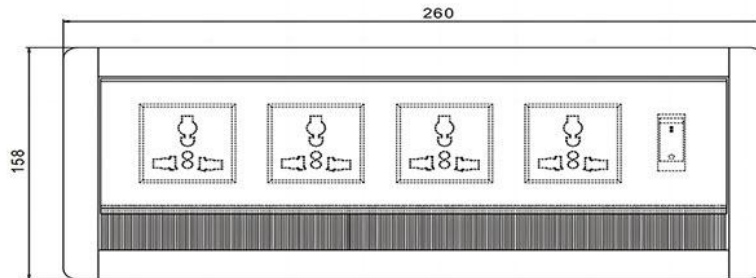

**B)45\*45mm modules&socket:**





C) Safewire pop up desksocket application in different system:



E) Safewire optional of economical package :

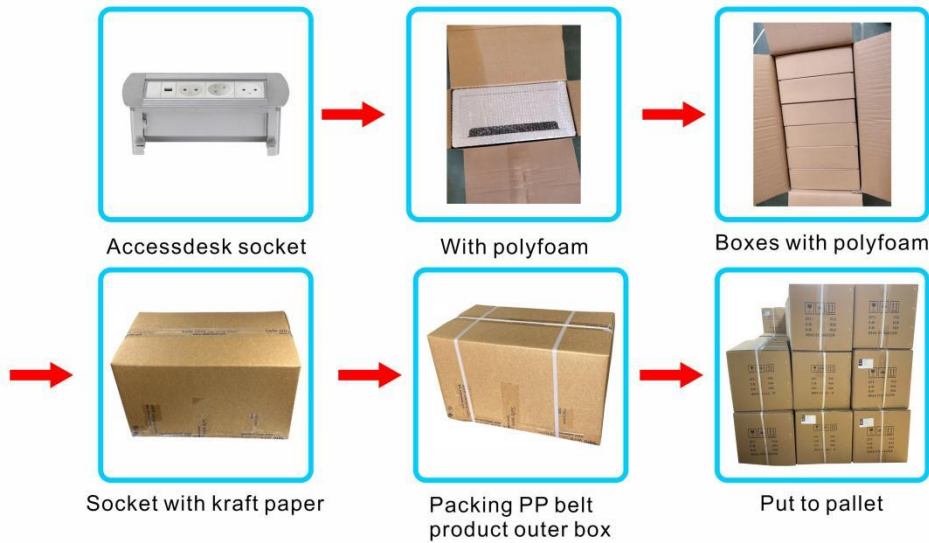

**Installation Process**

1. First, make holes in the table according to the appropriate size
2. Put the product into the cutting hole.

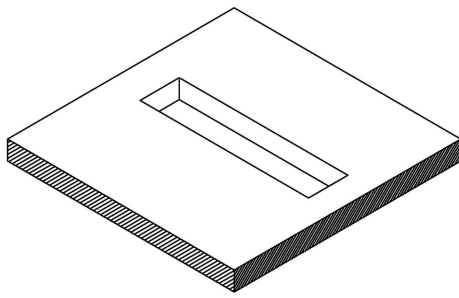

(1)

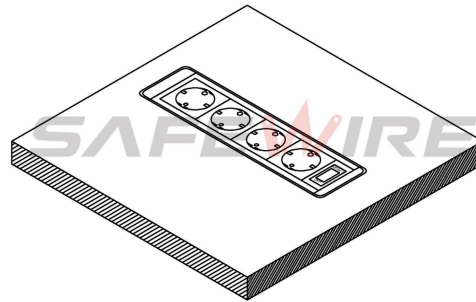

(2)

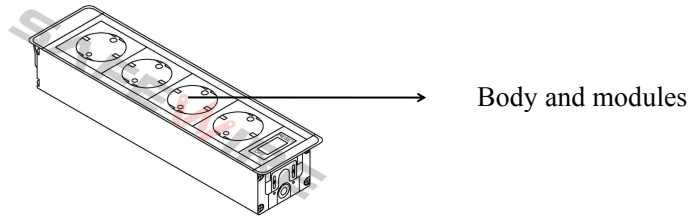

Body and modules

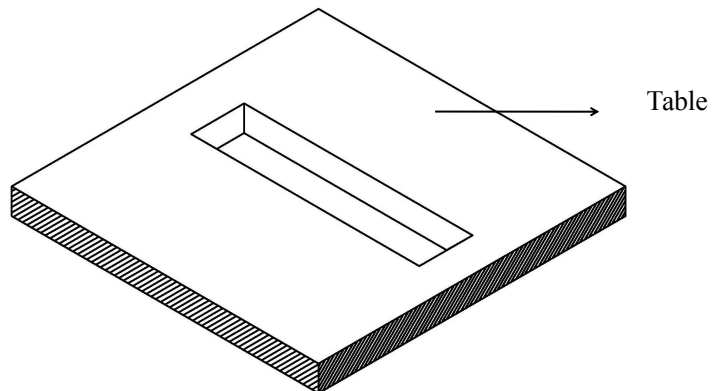

Table

**Attentions:**

- 1.Use only in normal temperature.Do not expose to conditions that harm to the product's safety,such as humidity,dusty and corrosives.
- 2.Properly connecting and installing according to the rated voltage ,frequency,rated current and function identification of the product



**SAFEWIRE**

Wenzhou Safewire Electric Co.,Ltd.

2nd floor, Wealth Garden, Liushi town, Yueqing, Wenzhou,China ,325604

3. All dimension quoted are nominal only. Drawings , images and text are for illustrative purposes only and product details and dimension are subject to change without notice.

**Safety Warning:**

- 1)This is a class I product and must be earthed.
- 2)This product must be installed/wired by a qualified electrician.
- 3)before installation/maintenance ,ensure the mains supply is switched off and the circuit fuses are removed or circuit breakers switch off.
- 4)For indoor use only.