

Wenzhou Safewire Electric CO.,Ltd.

# SPECIFICATION SHEET

**PRODUCT NAME:** Open coverplate

**PRODUCT No. :** HTD-102



ADD: 152 xinguang industrial zone, yueqing city, zhejiang province

(TEL) :0086-577-62799688

(E-mail) : info@safewirele.com

(WEB): <http://www.safewirele.com>



**Technical parameters & characteristic :**

**1) Working environment:**

1. The environment temperature:-5°C~/40°C
2. The rated voltage : 100V~~250V
3. Rated current : 10A、 13A、 16A、 20A

**2) Characteristic:**

<b>1</b>	<b>Model</b>	<b>HTD-102</b>	<b>6</b>	<b>HS Code</b>	8536690000
<b>2</b>	<b>Brand Name</b>	Safewire or OEM brand	<b>7</b>	<b>Market standard</b>	<b>Customized</b>
<b>3</b>	<b>Type</b>	floor socket	<b>8</b>	<b>Place of origin</b>	Zhejiang , Wenzhou, China
<b>4</b>	<b>Color</b>	Golden, silver, etc	<b>9</b>	<b>Frequency</b>	50Hz~60Hz
<b>5</b>	<b>Grounding</b>	Standard grounding	<b>10</b>	<b>Current Type</b>	AC

**3) Technical parameters :**

Serial No.	Parameter	Description
<b>1</b>	<b>Panel Material</b>	Brass alloy/Stainless-Steel
<b>2</b>	<b>Surface finish</b>	Wire drawing/Polishing/Spray painting
<b>3</b>	<b>Panel Dimension(mm)</b>	147*102
<b>4</b>	<b>Cutout(mm)</b>	134.5x77
<b>5</b>	<b>Capacity of modules</b>	4 ways modules
<b>6</b>	<b>Sink box Material</b>	Steel+Zinc plated
<b>7</b>	<b>Sink box Thickness</b>	1.0mm
<b>8</b>	<b>Inner box Size(mm)</b>	15.5x11.2x6.6
<b>9</b>	<b>Outer box Size(mm)</b>	36x33.5x35
<b>10</b>	<b>Available modules</b>	45*45/45*22.5(mm)
<b>11</b>	<b>N.W(kg)</b>	0.68 (Brass alloy);0.67(Alu alloy)
<b>12</b>	<b>G.W(kg)</b>	21.3 (Brass alloy);21.0(Alu alloy)
<b>13</b>	<b>Carton size(cm)</b>	36x33.5x35

**Application:**

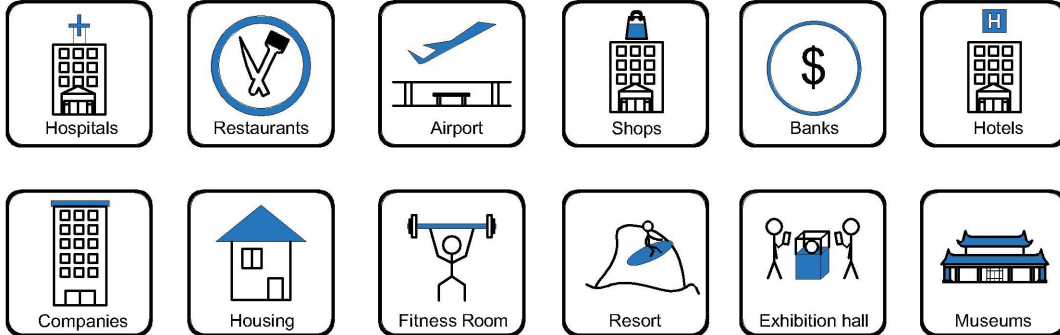

- Office and education
- Industry and Engineering
- Presentation and retail;
- Orientation and safety;
- Transit areas and parking;
- Hotels, hospitality and wellness;
- Health, sport and leisure;
- Art and culture;

**CE certificate by TUV,Germany**

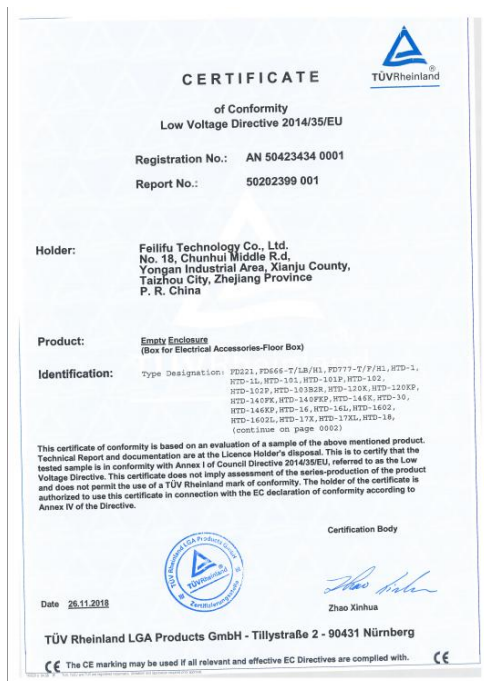

**LVD test report**

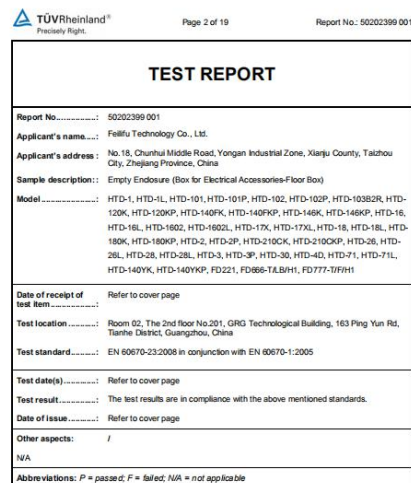



**SAFEWIRE**

Wenzhou Safewire Electric Co.,Ltd.

No.152 Xingguang Road, Xingguang industry zone, Liushi town, Yueqing, Wenzhou,China ,325604

**Product Show:**



Brass color



Silver color



Bottom box

**Features:**

- Nice appearance and safety design for floor management** :Stepped edge brass is available in plain polished (W) or antique bronze (ABZ) or simple polished rope edge(K) or standard soft edge in brushed (BR) or polished (PS) stainless steel. All with a choice of white or black interiors.
- Safety design:** Flush mount box of 1 Gang white insert under shaver Sockets.Surface seamless design and dust and impurities be protect into inside.
- Easy to Install:** Simple design as shaver sockets with spring loaded lid and supplied flush mount box with M3.5 X 30mm fixing screws.
- More Strong Scratch Resistance:** Surface finish made from stainless steel or Brass by combination of tough material, Aluminum (ADC12).
- Ultra slim panel only with thickness of 4mm;**
- Good socket receptacle materials increase service life:**Using elastic phosphor copper avoids playing spark plug and plug set to bit dead. Ensure high conductivity and more life of pulling and plugging over 15000 times.PC+ABS(1.Modules fireproof : 850 degree C temp.; 2.Modules don't distortion under 102 degree C temp.; 3.Stand under 15 degree C temp) ;Oxygen Insulation & Fire resistance in accordance with UL94 international standard.
- More heavy duty of bottom boxes:**Thickness of bottom boxes is over 1mm.  
Available for F type 45\*45mm type or D type23\*26mm international sockets or modules types:

**SAFEWIRE**

45 Type Function Accessories

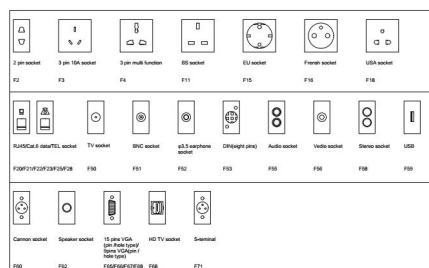



**SAFEWIRE**

Wenzhou Safewire Electric Co.,Ltd.

No.152 Xingguang Road, Xingguang industry zone, Liushi town, Yueqing, Wenzhou,China ,325604

**HTD-102 Outline drawing:**

Unit: mm

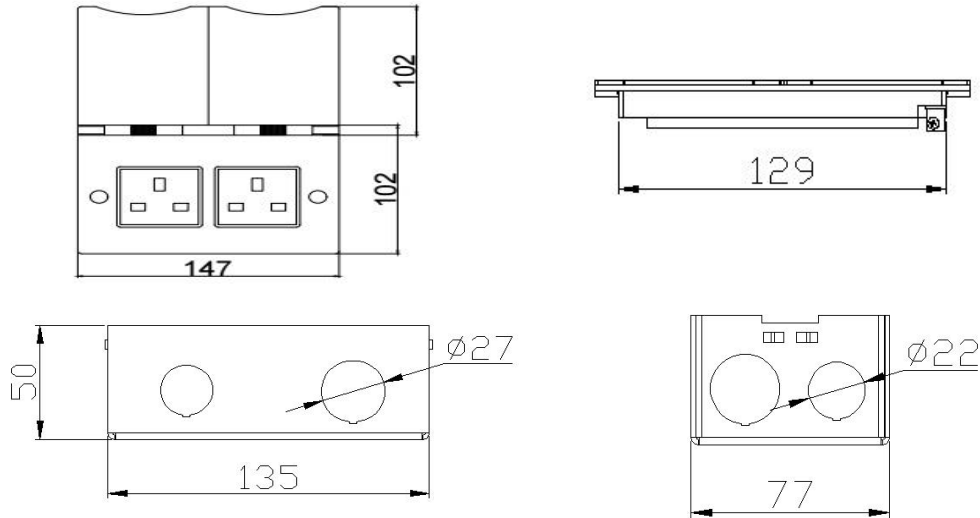

**Package:**30 Pcs inner box into a master carton.Poly bag with box packing.



**Installation Guide** (The exact products should be subject to confirmation by seller)

1. Cut out: insert sink box or floor box into flooring material
2. Dispose receptacle:Gently press the outlet and lift the lid to reveal the function keys inside.(Another way is to open the lid directly to expose the functional module).
3. Wiring: Insert the 10--12mm lead head into the terminal block.
4. Fix:Fix the flooring with spare screws on bottom box through embedded hole.

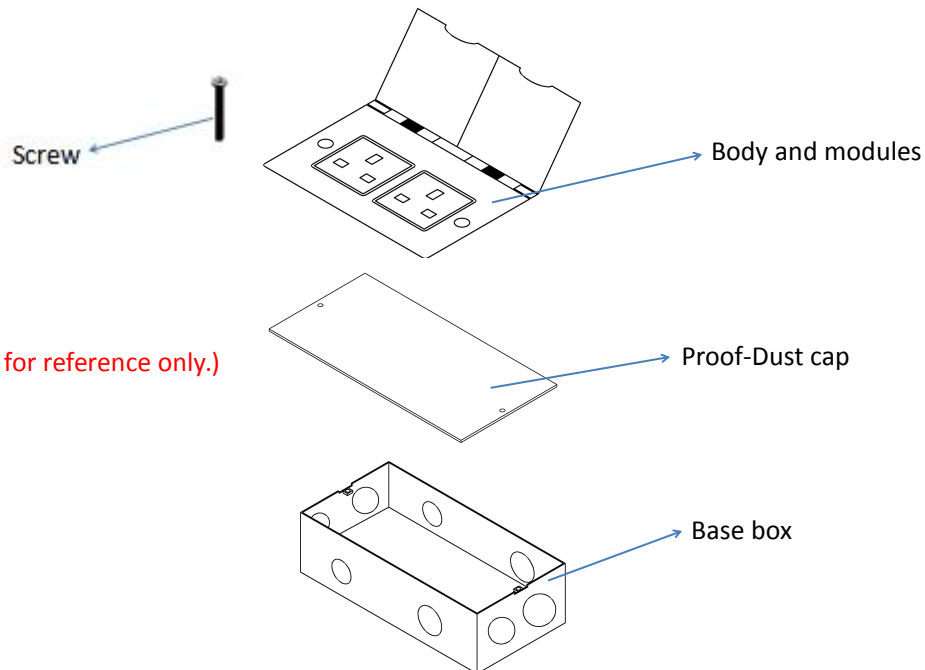
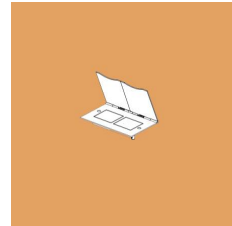
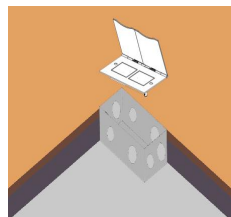
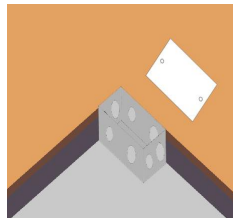

**Attentions:**

- 1.Dispose of trash in bottom box and prevent dirt and debris from entering inside.
- 2.When installing, pay attention to the opening direction,the length of the conductor to the bottom box shall not exceed 10cm,Set aside at least 200mm of cable.
- 3.When installing and wiring,avoid direct contact with corrosive liquid, gas (strong acid, strong alkali, paint).

**Safety Warning:**

- 1.This is a class I product and must be earthed
- 2.This product must be installed/wired by a qualified electrician
- 3.For indoor use only.
- 4.For concrete floor.