

Wenzhou Safewire Electric CO.,Ltd.

SPECIFICATION SHEET

PRODUCT NAME: Open coverplate

PRODUCT No. : HTD-101



HTD-101

ADD: 152 xinguang industrial zone, yueqing city, zhejiang province

(TEL) :0086-577-62799688

(E-mail) : info@safewirele.com

(WEB): <http://www.safewirele.com>



Technical parameters & characteristic :

1) Working environment:

1. The environment temperature:-5°C~/40°C
2. The rated voltage : 100V~~250V
3. Rated current : 10A、 13A、 16A、 20A

2) Characteristic:

1	Model	HTD-101	6	HS Code	8536690000
2	Brand Name	Safewire or OEM brand	7	Market standard	Customized
3	Type	floor socket	8	Place of origin	Zhejiang , Wenzhou, China
4	Color	Golden, silver, etc	9	Frequency	50Hz~60Hz
5	Grounding	Standard grounding	10	Current Type	AC

3) Technical parameters :

Serial No.	Parameter	Description
1	Panel Material	Brass alloy/Stainless-Steel
2	Surface finish	Wire drawing/Polishing/Spray painting
3	Panel Dimension(mm)	81*102
4	Cutout(mm)	80x82
5	Capacity of modules	2 ways modules
6	Sink box Material	Steel+Zinc plated
7	Sink box Thickness	1.0mm
8	Inner box Size(mm)	10.5x6.5x10.5
9	Outer box Size(mm)	54x34x23
10	Available modules	45*45/45*22.5(mm)
11	N.W(kg)	0.44 (Brass alloy);0.43(Alu alloy)
12	G.W(kg)	23 (Brass alloy);22.4(Alu alloy)
13	Carton size(cm)	54x34x23

Application:

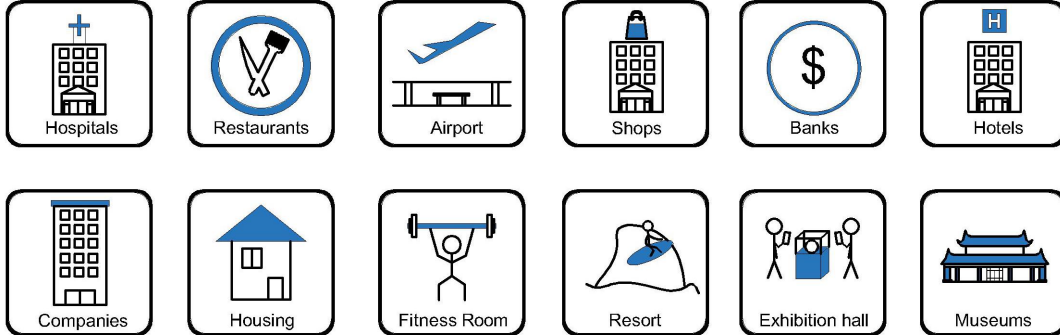

- Office and education
- Industry and Engineering
- Presentation and retail;
- Orientation and safety;
- Transit areas and parking;
- Hotels, hospitality and wellness;
- Health, sport and leisure;
- Art and culture;

CE certificate by TUV,Germany

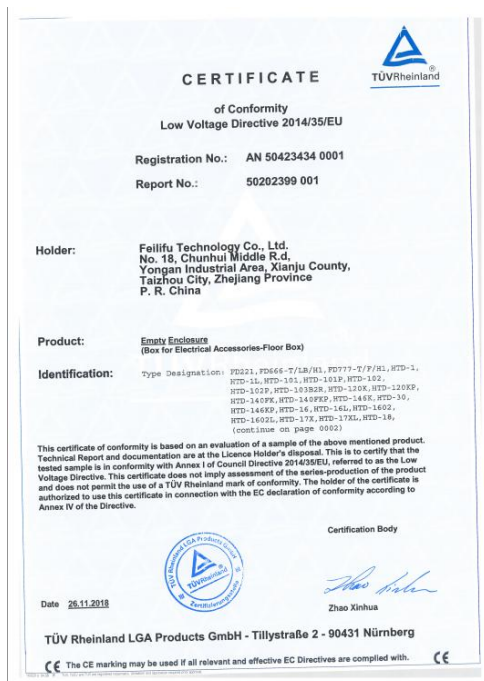

LVD test report

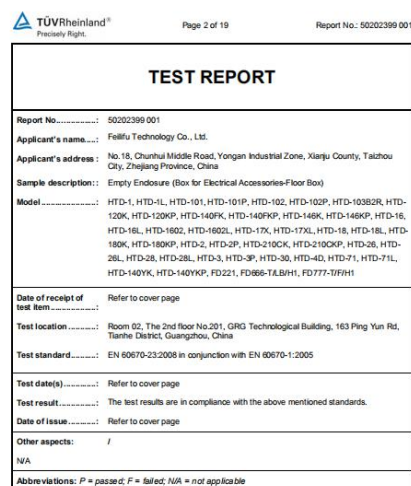



SAFEWIRE

Wenzhou Safewire Electric Co.,Ltd.

No.152 Xingguang Road, Xingguang industry zone, Liushi town, Yueqing, Wenzhou,China ,325604

Product Show:

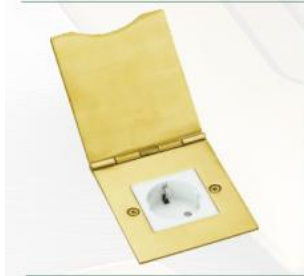

Brass color



Silver color



Bottom box

Features:

1. More Strong Scratch Resistance from Brass/Stainless.
2. Ultra slim panel < 4mm.
3. Standard 86*86 type for flush mounting bottom box

Available for F type 45*45mm type or D type 23*26mm international sockets or modules types:

SAFEWIRE

45 Type Function Accessories

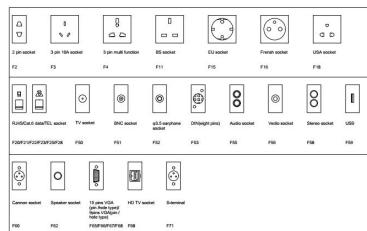



SAFEWIRE

Wenzhou Safewire Electric Co.,Ltd.

No.152 Xingguang Road, Xingguang industry zone, Liushi town, Yueqing, Wenzhou,China ,325604

HTD-101 Outline drawing

Unit: mm

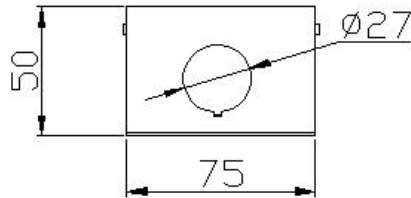
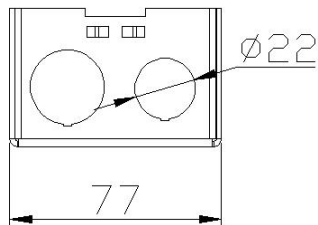
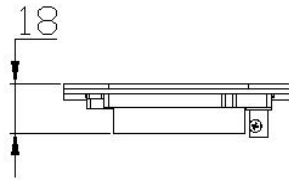
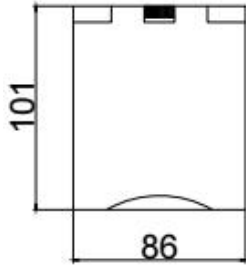

Package:50 Pcs inner box into a master carton.Poly bag with box packing.





SAFEWIRE

Wenzhou Safewire Electric Co.,Ltd.

No.152 Xingguang Road, Xingguang industry zone, Liushi town, Yueqing, Wenzhou,China ,325604

Installation Guide (The exact products should be subject to confirmation by seller)

1. Cut out: insert sink box or floor box into flooring material
2. Dispose receptacle:Gently press the outlet and lift the lid to reveal the function keys inside.(Another way is to open the lid directly to expose the functional module).
3. Wiring: Insert the 10--12mm lead head into the terminal block.
4. Fix:Fix the flooring with spare screws on bottom box through embedded hole.

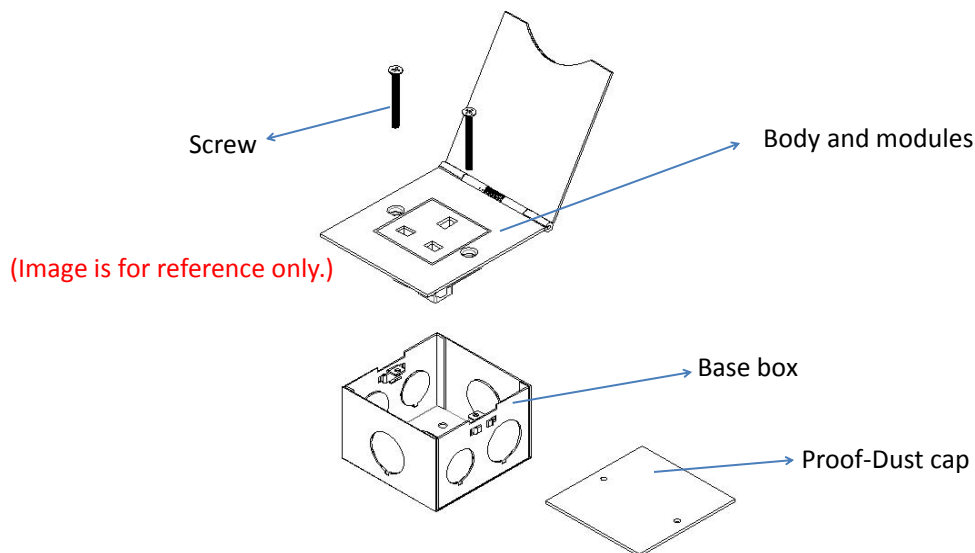
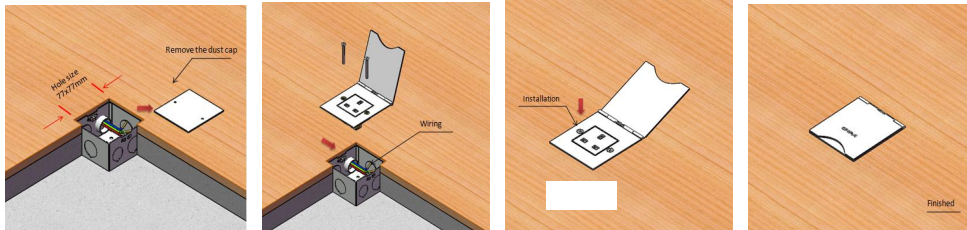

Attentions:

- 1.Dispose of trash in bottom box and prevent dirt and debris from entering inside.
- 2.When installing, pay attention to the opening direction,the length of the conductor to the bottom box shall not exceed 10cm,Set aside at least 200mm of cable.
- 3.When installing and wiring,avoid direct contact with corrosive liquid, gas (strong acid, strong alkali, paint).

Safety Warning:

- 1.This is a class I product and must be earthed
- 2.This product must be installed/wired by a qualified electrician
- 3.For indoor use only.
- 4.For concrete floor.